



## SURFACE SQUARE 6 OR 12 VOLT EMERGENCY LIGHT

These low profile decorative fixtures are best for general, non-directional illumination

### SPECIFICATIONS

**CONSTRUCTION:** Extruded aluminum housing has a matte white finish; the back box is constructed of heavy gauge steel and is finished satin black. Clear prismatic acrylic lens, standard.

**MOUNTING:** Surface or semi-recessed mounting. (Bar hanger brackets optional) knockouts provided for universal mounting to wall or ceiling.

**LAMPS:** Furnished with two (2) 6V or 12V wedge base lamps which illuminate when power fails. (Optional AC illumination).

**BATTERY:** Sealed maintenance free lead acid battery operates lamps for a minimum of 90 minutes.

**CHARGING CIRCUITRY:** Solid state charger features automatic brown-out protection and low voltage disconnect. A momentary test switch and charge indicating light are standard.

Dual 120/277 Volt Input.

LABELS: U.L. / E.T.L. Listed.

WARRANTY: See warranty page.

### DIMENSIONS

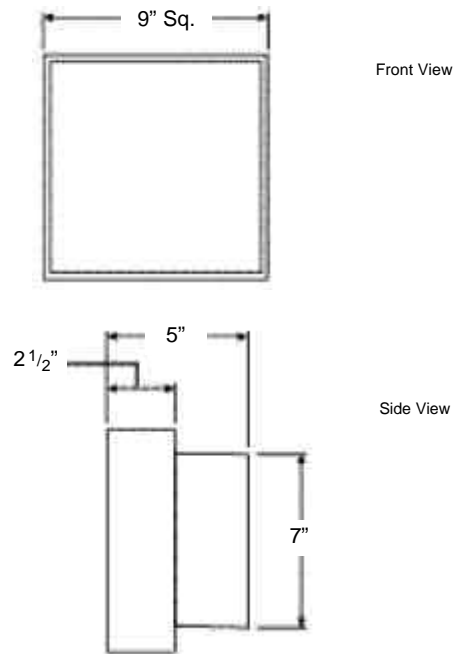

SQS SERIES

### ORDERING INFORMATION

Example: SQS-INC-MOD

SQS		
<input checked="" type="checkbox"/> <b>Series</b>	<input checked="" type="checkbox"/> <b>Voltage</b>	<input checked="" type="checkbox"/> <b>Options</b>
<input type="checkbox"/> SQS- Surface Square	<input type="checkbox"/> 6- 6 Volt <input type="checkbox"/> 12- 12 Volt	<input type="checkbox"/> AC-INC-2-20T6.5 DC Bayonet Base Lamps <input type="checkbox"/> AC-FL-2 7/9Watt PL Lamps <input type="checkbox"/> V-Voltmeter <input type="checkbox"/> A-Ammeter <input type="checkbox"/> BH-Bar Hanger Brackets <input type="checkbox"/> H-Halogen Lamp <input type="checkbox"/> NCB-Nickel Cadmium Battery <input type="checkbox"/> MOD-Special Finished Trim

NOTE: Specifications and dimensions subject to change without notice

